

MWP-302 LA CONNECTIONS

The MWP-302 has a newer, easier way to integrate the existing Line Monitoring solutions from Webb Electronics. Instead of requiring the expansion board to connect the Lobby Alert System, there is a built-in normally open (NO) relay to which you can connect the Lobby Alert System.

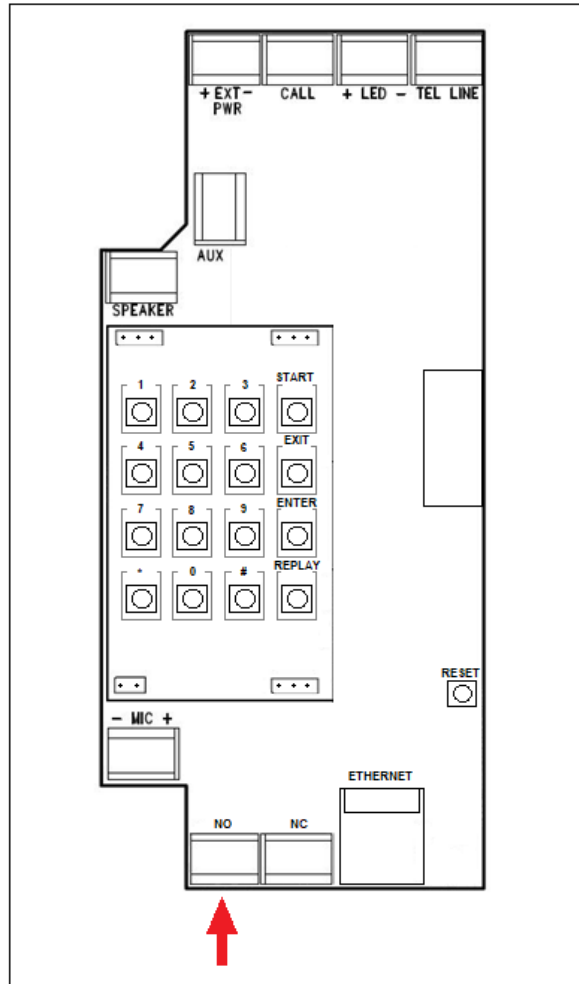

Figure 1- MWP-302 NO Dry contact.

Note: The MWP-302 still supports the same expansion boards as the MWP-150. However, for the LAS Connection, the expansion board is now completely optional.

PHONE LINE MONITORING SYSTEM TYPICAL WIRING DIAGRAM

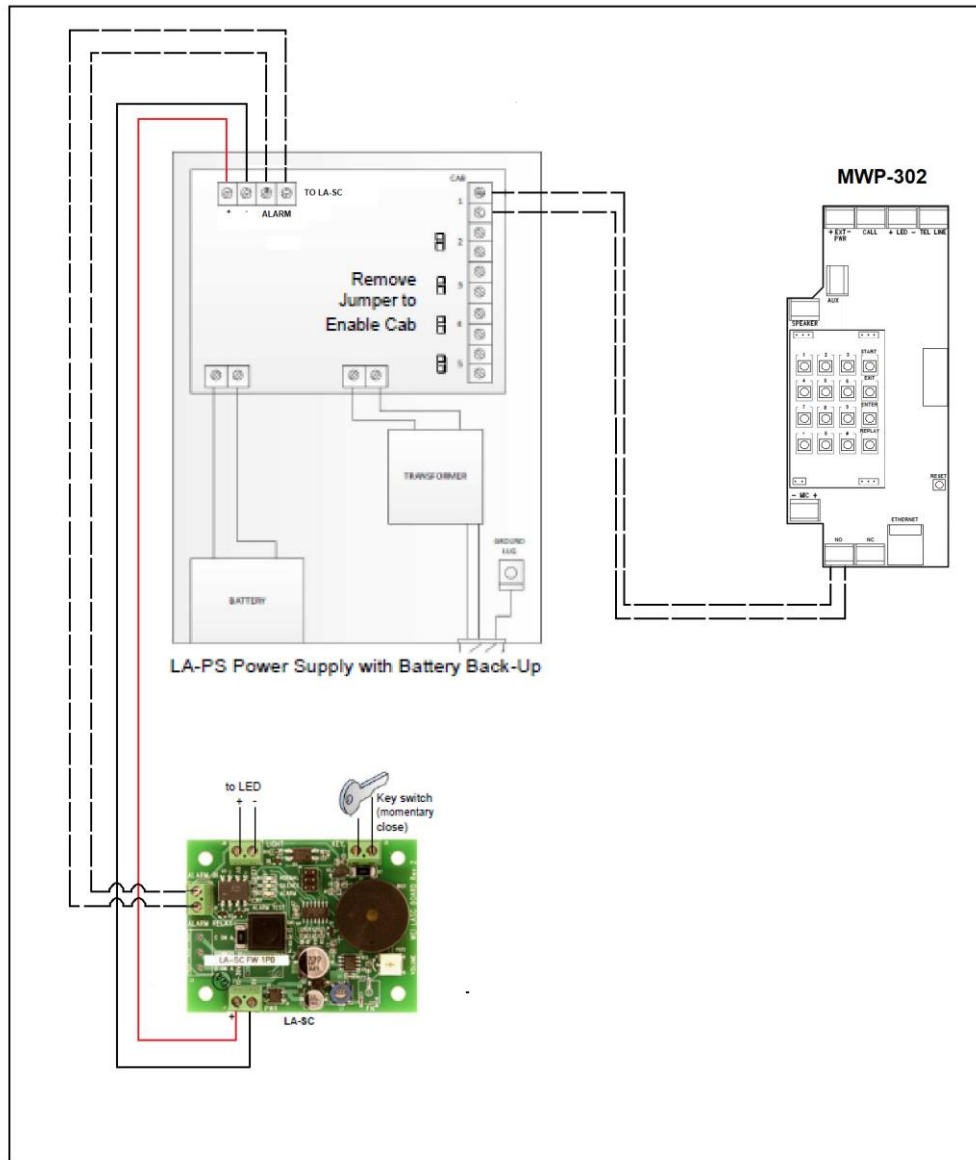

Figure 2 – MWP-302 Line monitoring wiring.